

# THE ADDRESS



# ECO LUXURY APARTMENTS

---





**DISTANCES**



**PGI**

PGI  
5 Mins



Sector 43 ISBT  
10 Mins



Lake  
20 Mins



Sector 17  
8 Mins



Panjab  
University  
5 Mins



International  
Airport  
20 Mins



Cricket  
Stadium  
2 Mins



**ALL AROUND  
ACCESSIBILITY  
FOR YOUR NEEDS**

# Chandigarh Newsline

The Indian EXPRESS

Vol XXV No 244, SATURDAY, AUGUST 4, 2016

WWW.INDIANEXPRESS.COM, TWITTER.COM/INDIANEXPRESS, FACEBOOK.COM/INDIANEXPRESS, INDIANEXPRESS/APP



TALK  
Page 4  
A Step  
in Time

**ADMISSION NOTICE**  
**IAS-2019**  
 Registration Open till 05th August  
 Weekend Batch Starts : 11th August  
 Regular Batch Starts : 15th August

**SAMKALP**  
 IAS Coaching Centre - An NGO  
 9914123332  
 9815566664  
 Block-1, Fl. Sector 29 A, Chandigarh

## New cricket ground may host int'l match next year

Work on the new stadium at Mullanpur continues on war footing

**NITIN SHARMA**  
 MICHAEL AUGUST 2

AS PUNJAB Cricket Association (PCA) groundman Babu Lal describes the grass-planting process to fellow workers in the three-layer seven-pitches area of the new International Cricket Stadium at Togan and Tina villages in Mullanpur, New Chandigarh, a ground official descends the stairs to enter the ground from the under-construction players' dressing rooms. Unlike the IS Bindra PCA Stadium in Mohali, the new stadium, which is almost 50:55 per cent complete, will have dressing rooms on the first floor with players walking on the ground and Punjab Cricket Association plans to host an international match at the new stadium in Sector 38-Baddi by next year.

The stadium work has been going on within the targeted time-frame and if things go as planned, Punjab Cricket Association may host one of the matches of the yet to be announced Indian series to be held in October-November 2016. The first phase of the stadium will be fully complete by January 2020 and we will also host Ranji Trophy matches at the stadium next season. The basic infrastructure of the stands is almost complete with the South Stand and North Stand top floors almost in shape. The players' dressing rooms are on the first floor and the players will come to the ground by the stairs. Besides, the dressing rooms will have saunas and gym facilities. Regular checkings are being done by the technical committee of Punjab Engineering College," said PCA Secretary R P Singh.

The 38.2-acre stadium, where construction work began in



Work in progress at new PCA International Stadium at Mullanpur near Chandigarh on Friday. Kamaldeep Singh

January last year, was conceptualised by I S Bindra, then PCA president, and the new stadium will have six stands with a total capacity of 38,000. The two general stands will have a total of

18,000 seats. The South Stand will see a corporate pavilion having a capacity of 6,000 with

South Pavilion and players pavilion having a combined capacity of 12,000. This stadium will see the ground floor stand running through the stadium, offering more fans a closer view of the matches. The work has been ahead of the target and once the necessary permissions are given, it will be ready to host international matches," said D K Basso, Project Director of the stadium.

The stadium will also have 3 D Lite Poly Carbonate Sheet Roofing on the top of each three-tier stand apart from having eight camps for the stands. There will be 30 corporate boxes in the South Stand apart from 20 camera points in the stands. The Poly Carbonate roof will add a special touch to the stadium. In an emergency, the cricket fans can be evacuated in under six minutes as there are eight ramps and more than 20 lifts at the stadium. All the points for electronic coverage have also been made under the outfield and stands. The work on the stadium started along with the construction of the buildings," said Jatinder

Moham, Project Manager.

The new stadium will also see seven clay-based pitches apart from a Herringbone water drainage system, one of the firsts in the region. The ground has been laid with Bermuda Evergreen grass with the pitches having Bermuda grass. The seven-pitches area has been made with three layers of soil. It consists of 75 per cent black clay soil brought from Haryana with three levels. The grass-laying process on the pitches has begun while the grass-laying process on the outfield has been completed. We also had Herringbone water drainage system, which offers 30-mm drainage time in case of rain. The outfield also has a tile with a ratio of 1:100 and a submergent point being three feet higher than the p area. We may also decide to make red-soil pitches out in the ground B and nets turf," said Daljit S Chairman, Grounds and Committee, PCA, and al Chief Curator of BCCI.

NSUI 'poster boy' was arrested with notorious gangster Sampat Nehra in 2016

30-year-old biker killed after being hit by scooter



# Tata cancer hospital likely to begin operations next year

100-bed facility coming up in New Chandigarh at cost of ₹480 cr

**NITIN JAIN**  
TRIBUNE NEWS SERVICE

CHANDIGARH, JULY 7

The work to build Tata Memorial Centre (TMC) Hospital at the Medicity in New Chandigarh, close to the PGI here, has reached advanced stage and is likely to be completed within a year.

The Union Department of Atomic Energy (DAE) had last year awarded the construction work of the hospital, christened as Homi Bhabha Cancer Hospital and Research Centre, to Shapoorji Pallonji Group, a top TMC functionary told The Tribune here on Saturday.

"The total cost of the project is Rs 480 crore. It includes cost of equipment and construction. The present contract is only for construction and the total amount is Rs 218 crore plus taxes," he disclosed.

The TMC functionary said the project was in advanced stage of completion and was scheduled to be completed by

## ABOUT THE PROJECT

The Union Department of Atomic Energy will spend ₹480 crore on setting up the 100-bedded second-of-its-type cancer hospital, on the lines of the TMC Hospital in Mumbai.



According to the project report, it would be a "world-class institution for a noble cause" with a mandate for service, education and research.

The institution will aspire to be a tertiary care centre for cancer, promoting prevention, cure, rehabilitation and palliation for the population of Punjab, Haryana, Himachal Pradesh, Jammu and Kashmir, Rajasthan, Uttarakhand and Uttar Pradesh.

May next. "The facility would be made fully operational around third quarter of the next year," he added.

The development assumes significance as it will be the second-of-its-type, state-of-the-art cancer institute, the foundation stone of which

was laid by former Prime Minister Dr Manmohan Singh on December 30, 2013.

A visit to the site revealed that the RCC structural work of the main hospital building (proposed as ground plus six floors) has been completed

CONTINUED ON PAGE 2

ina child actor from Mohali basks in  
Gurjot Kaur, a Class IV student, plays the role of Gurdas Maan's son in

Crim  
the te  
tuted  
drug  
city.  
drugs

Food  
ma  
at k

TRIBUNE

PANIC  
An Ube  
robbed  
at knife  
here on

Accord  
available  
a residen  
in his cor  
submitte  
night, he  
home af  
last order

When h  
20, a whit  
to stoppe  
Two peop  
car with  
They robb  
and his m  
escaping

On Zabb  
FIR unde  
bery) of  
Code has  
the Sector

Speaktir  
of a child  
family to

...happy. I felt very nice on seeing myself

# TATA CANCER HOSPITAL



**NARSEE MONJEE UNIVERSITY**



The Oberoi's Resort at New Chandigarh







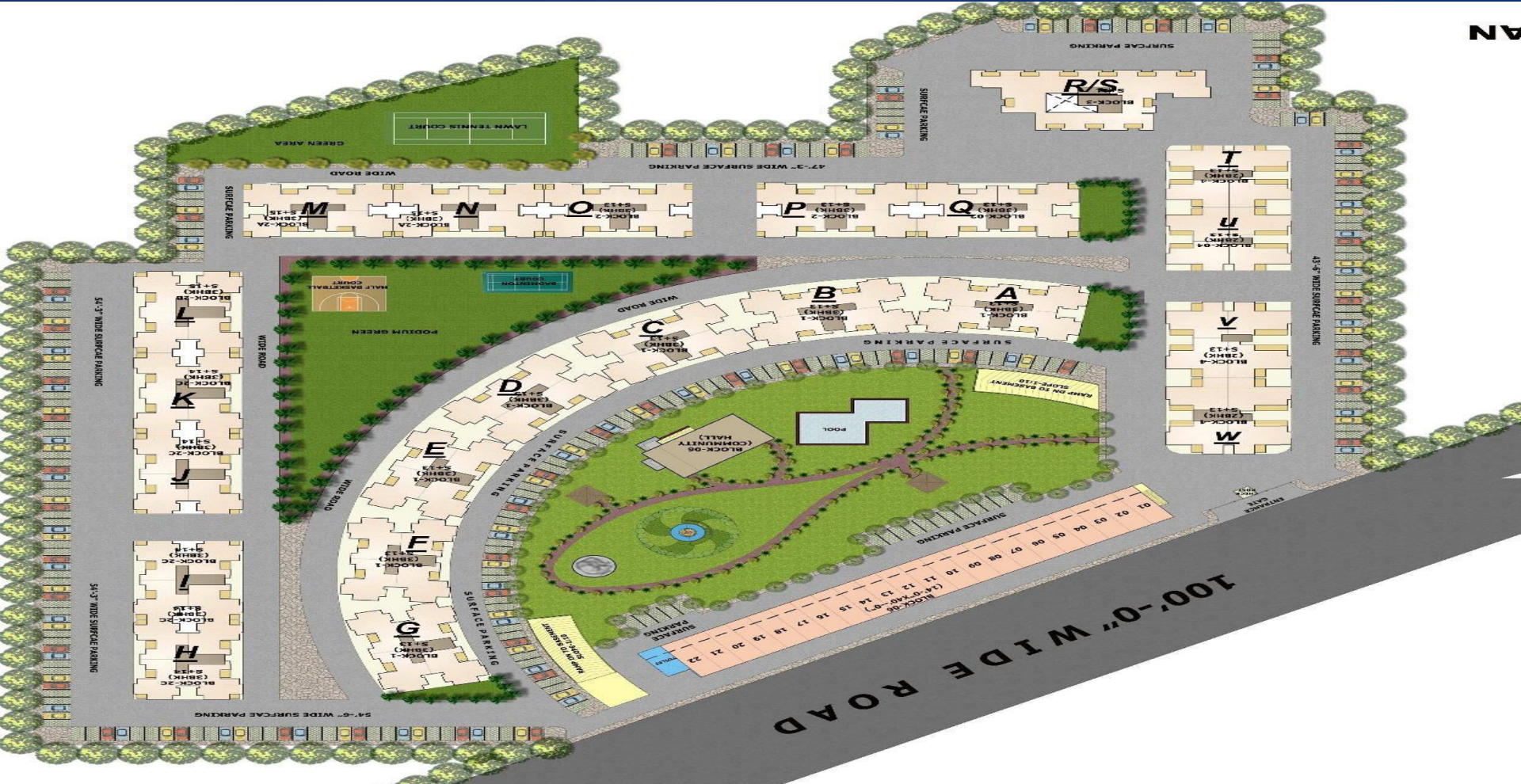



LUSH GREEN LAWNS



JOGGING TRACK



KIDS PLAY AREA



COVERED PARKING



INTERCOM FACILITIES



MODULAR KITCHEN



EARTHQUAKE RESISTANT



RCC STRUCTURE



24 X 7 SECURITY



EMERGENCY SERVICES



100% POWER BACKUP



SEPARATE REST ROOM



SEPARATE LIFT FOR EACH BLOCK



BROADBAND PROVISION



UNINTERRUPTED WATER



UNDERGROUND DRAINAGE



WIDE & WELL LIT ROADS



DTH FACILITY PROVISION

**2 BHK**  
**APARTMENTS**  
**850 Sq. feet**



## 3 BHK APARTMENTS- 1150 Sq. feet



# 3 BHK PROPOSED LAYOUT

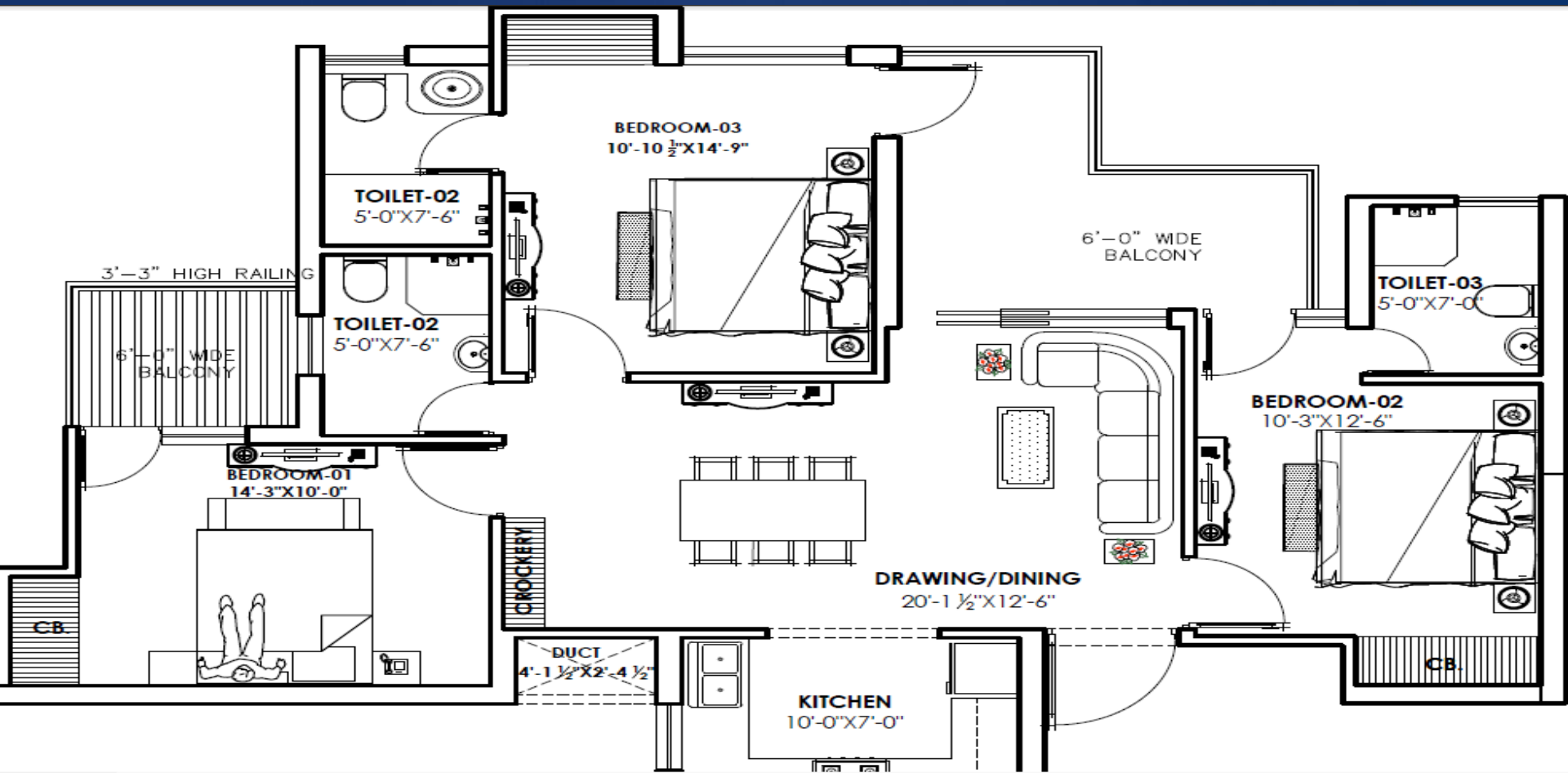



## SPECIFICATIONS



### LIVING / DINNING ROOM

- Flooring : Vitrified tiles
- Wall Finishing : Luster paint/OBD
- Fittings : Doors-paneled polished main entrance & Internal Wooden Frames with Laminated Flush Doors
- Windows : UPVC



### BED ROOMS

- Flooring : Wooden Flooring in Master Bed Room & Vitrified Tiles Other Bed Room
- Wall finishing : Luster paint/OBD
- Fittings : Doors-paneled polished main entrance & Internal Wooden Frames with Laminated Flush Doors
- Windows : UPVC



### KITCHEN

- Flooring : Anti-Skid Ceramic Tiles
- Wall finishing : Luster paint/OBD
- Fittings : Pre-Fitted A.C Fittings in all rooms
- Platform : Granite top with 2 feet Ceramic Tiles above Counter
- Windows : UPVC



### WASHROOMS

- Flooring : Anti-Skid Ceramic Tiles
- Wall finishing : Ceramic Tiles up to Roof Top
- Fittings : Wire-Copper (Polycab/Havells)
- Windows : UPVC



### BALCONY

- Flooring : Anti-Skid Ceramic Tiles
- Wall finishing : Weather Proof Paints
- Railing : MS
- Windows : UPVC

### STAIRCASE & LIFT LOBBY

- Flooring : Granite
- Wall finishing : Weather Proof Paints
- Railing : MS

— OUR PROJECTS —

- THE ADDRESS
- ADDRESS BOULEVARD
- ADDRESS SQUARE
- ADDRESS ARENA
- ADDRESS GLOBAL CITY



# Avail the PMAY...



# PRICE LIST & PAYMENT PLAN



DESCRIPTION	3 BHK Area 1150/-Sq.f.t	2 BHK Area 850/-Sq.f.t
Basic Sale Price (BSP)	₹ 46,90,000/-	₹ 36,90,000/-
Preferential Location Charges A Park*	₹ 5% of BSP	₹ 5% of BSP
Preferential Location Charges B Corner*	₹ 5% of BSP	₹ 5% of BSP
Preferential Location Charges C 1st Floor*	₹ 2,00,000/-	₹ 1,50,000/-
2nd Floor*	₹ 1,50,000/-	₹ 1,00,000/-
3rd Floor*	₹ 1,00,000	₹ 50,000/-
Club Membership	₹ 75,000/-	₹ 50,000/-
Covered Car Parking Charges	₹ 75,000/-	₹ 75,000/-
Power Back up	₹ 75,000/-	₹ 50,000/-
IFMS	₹ 15/- Per Sq.ft.	₹ 15/- Per Sq.ft.

## Payment Plan - Construction Plan

S. No.	Schedule of Payment	PERCENTAGE (0%) OF BSP + GST
1.	At the time of Booking	(10% OF BSP) + GST
2.	On Agreement within 10 Days of Booking	10% + GST
3.	On Starting of Excavation	10% + GST
4.	On Foundation	10% + GST
5.	On Completion of 2nd Floor Slab	10% + 50% of CLUB Charges + GST
6.	On Completion of 4th Floor Slab	7.5% + 50% of CLUB Charges + GST
7.	On Completion of 6th Floor Slab	7.5% + GST
8.	On Completion of 8th Floor Slab	7.5% + GST
9.	On Completion of 10th Floor Slab	7.5% + GST
10.	On Completion of 13th Floor Slab	7.5% + GST
11.	On Completion of External Finishing	7.5% + GST
12.	At the time of Possession	5% + GST

## Terms & Conditions

- Bank Draft/Cheque to be issued in favor of ADDRESS INFRASTRUCTURES PVT. LTD
- Prices, Terms & Conditions Stated here in are merely indicative with a view to acquaint the applicant and are not Exhaustive, for detailed Terms & Conditions please refer to the standard Builder Buyer's agreement, which will be executed after allotment of property.
- Prices are escalation free & subject to change without any prior notice, Booking at the sale discretion of the company, Prices rulling on the date of booking shall be applicable,
- EDC, IDC, Registration charges, Stamp Duty, GST & other applicable statutory taxes/charges levies etc.
- Terms & Conditions apply.
- The Above Mentioned payment plan may vary a little bit in case of those opting for bank funding, plans will be as approved by various banks.

Signature.....  
1st Applicant

Signature.....  
2nd Applicant

Signature.....  
3rd Applicant



**AL FARA'A GROUP**  
CONSTRUCTION ▲ PROPERTIES ▲ INDUSTRIES



## ABOUT AL FARA'A INFRAPROJECTS PVT. LTD.



First time in the Tricity, the construction is to be done by Dubai based AL Fara'a Infraprojects Pvt. Ltd having their office in Bangalore & Mumbai by using MIVAN TECHNOLOGY.

Al Fara'a Infraprojects has started its operation in India since 2011 to take up and execute construction projects like, residential, commercial, multistoried buildings of high rise towers, healthcare, heritage structures, hotels, multiplexes, villas and shopping malls, etc. on EPC basis including Civil and MEP Works, HVAC, Fire Fighting, Interiors, BMS, Interior Works, External Development works etc. Since 2011, we have been executing residential and commercial projects for our prestigious clients like, Lodha Group, JP Infra, Patel Realty, Tata Housing, Prestige Group, etc.

Al Fara'a General Contracting, licensed as a Special Grade Company by the UAE Government has achieved a track record of Excellence spanning multiple types of projects of different configurations and magnitudes. The construction and related services segment of the Al Fara'a Group also includes an investment arm mechanical, electrical and plumbing supply and services delivered by Al Sabbah Electromechanical, exterior and interior finishing and precast and steel structures.

# CONSTRUCTION UPDATE



# CONSTRUCTION UPDATE



# CONSTRUCTION UPDATE



**W Tower**  
**2 BHK**



**A Tower**  
**3 BHK**

# THE ADDRESS

**Address Infrastructures Pvt Ltd**  
**Sector 17 New Chandigarh (India)- 160014**

